

**earthcore**<sup>®</sup>

**We Make Fire...Better.**

[earthcore.co](http://earthcore.co)

# EcoSteel Air-Cooled Chimney

**THE LIGHTWEIGHT ECO-STEEL VENTING SOLUTION** securely connects each flue section using a locking-tab design, ensuring immediate and tight assembly. With a 12 5/8" inner diameter and a 15 5/8" outer diameter, it is rated for any solid fuel Isokern Fireplace. This versatile system has been tested and approved for use with Isokern Standard and Magnum fireplaces in typical or Fire-Lite applications.



**Air-Cooled Chimney Flue**

6" - 13ACECO6  
12" - 13ACECO12  
18" - 13ACECO18  
36" - 13ACECO36  
48" - 13ACECO48



**Air-Cooled Anchor Plate**

13ACECOAP



**Air-Cooled Anchor Plate with Damper**

13ACECOAPD



**Air-Cooled 15° Offset**

13ACECO15OS



**Air-Cooled 30° Offset**

13ACECO30OS

## For Both EcoSteel & EcoSteel+



**Round Chimney Cap**  
Stainless Steel  
13ACECOCC



**Firestop Assembly**  
13ACECOFS



**Support Band**  
4 pack  
13ACECOSB



**Chase Flashing**  
13ACECOFC



**Attic Insulation Shield**  
13ACECOIS



**Rain Cap**  
for Shroud Installation  
13ACECORC



**Tall Cone Flashing**  
13ACECOFT



**Storm Collar**  
13ACECOSC



**Adjustable Support**  
13ACECOAS



**Wall Band**  
13ACECOWB

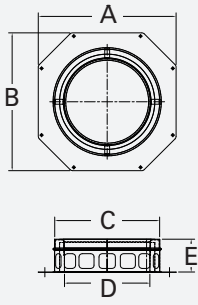

**13ACECOAP - Dimensions:**

- A. 21.000
- B. 21.000
- C. 16.000 I.D.
- D. 13.000 I.D.
- E. 5.000

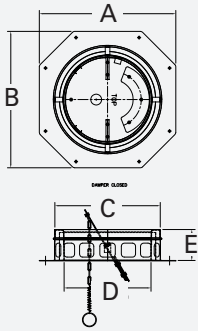

**13ACECOAPD - Dimensions:**

- A. 21.000
- B. 21.000
- C. 16.000 I.D.
- D. 13.000 I.D.
- E. 5.000

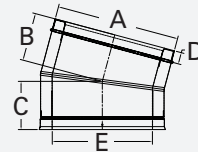

**13ACECO15OS - Dimensions:**

- A. 16.000 I.D.
- B. 6.250
- C. 6.250
- D. 1.500
- E. 13.000 I.D.

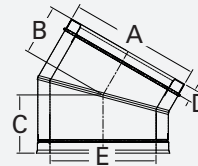

**13ACECO30OS - Dimensions:**

- A. 16.000 I.D.
- B. 6.148
- C. 7.148
- D. 1.500
- E. 13.000 I.D.

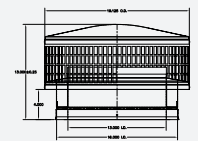

Stainless Steel

**13ACECOCC - Dimensions:**

- A. 19.125 O.D.
- B. 13.000 ± 0.25
- C. 13.000 I.D.
- D. 4.000
- E. 16.000 I.D.



**13ACECOFC - Dimensions:**

- A. 1.000
- B. 4.250
- C. 20.000 O.D.
- D. 26.250 Square

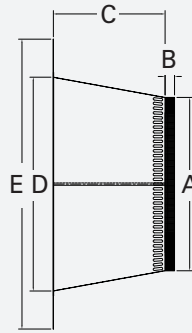

**13ACECOFT - Dimensions:**

- A. 18.250 O.D.
- B. 1.000
- C. 11.750
- D. 22.500 O.D.
- E. 30.500 Square

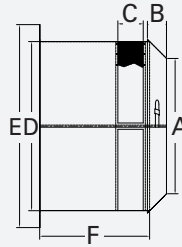

**13ACECOIS - Dimensions:**

- A. 16.000 I.D.
- B. 2.250
- C. 3.000
- D. 20.000 O.D.
- E. 24.000 Square
- F. 13.000

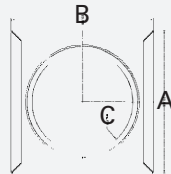

**13ACECOFS - Dimensions:**

- A. 23.188
- B. 23.188
- C. 16.375

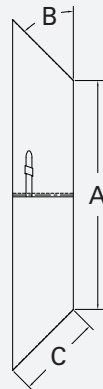

**13ACECOSC - Dimensions:**

- A. 16.000 I.D.
- B. 45°
- C. 6.000

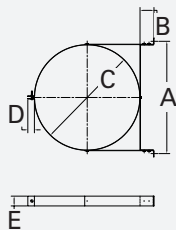

**13ACECOWB - Dimensions:**

- A. 17.125
- B. 2.000
- C. 16.036 I.D.
- D. 1.000
- E. 1.500

**How It's Assembled:**

